

# Resort Floor Plan

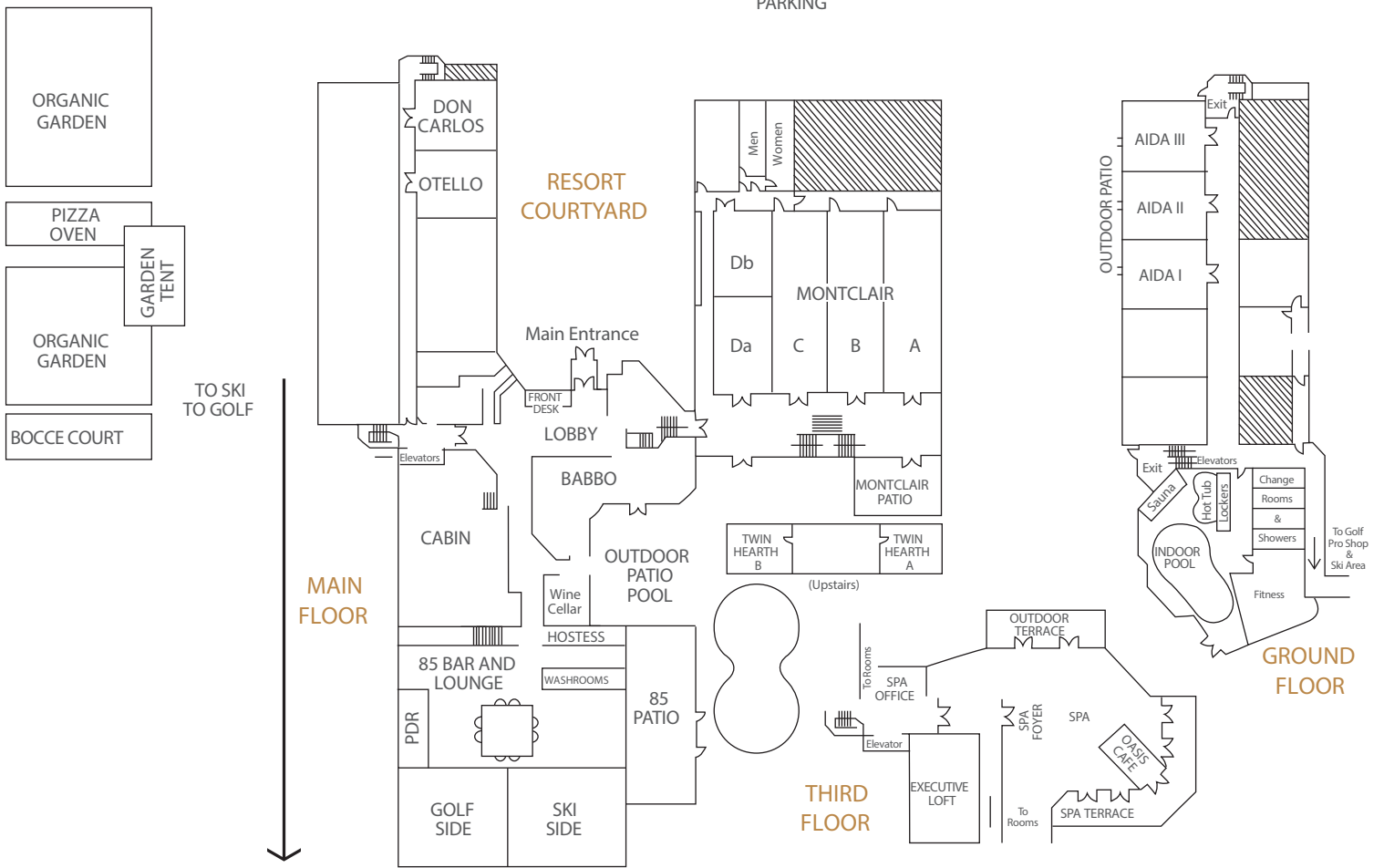

# Meeting Room Specifications

| Room                 | Size          | Height | Footage | U-Shape | Rounds of 6 | Boardroom | Classroom | Theatre & Reception | Dinner  |
|----------------------|---------------|--------|---------|---------|-------------|-----------|-----------|---------------------|---------|
| Montclair (all)      | 88' x 63'     |        | 5544    | 88      | 180         | 74        | 200       | 550                 | 450     |
| Montclair (half)     | 44' x 63'     |        | 2772    | 44      | 90          | 38        | 100       | 250                 | 160     |
| Montclair A/B/C/D    | 22' x 63'     | 12'    | 1386    | 36      | 42          | 34        | 48        | 100                 | 64      |
| Montclair Da         | 22' x 33'     | 12'    | 726     | 20      | 24          | 18        | 24        | 50                  | 32 - 40 |
| Montclair Db         | 22' x 30'     | 12'    | 660     | 16      | 24          | 14        | 16 - 20   | 50                  | 32      |
| Twin Hearth A        | 20' x 26'     | 8'     | 520     |         |             | 16        |           |                     |         |
| Twin Hearth B        | 20' x 36'     | 8'     | 720     |         |             | 22        |           |                     |         |
| Don Carlos & Otello  | 28.7' x 51'   | 8'     | 1470    | 36      | 48          | 34        | 48        | 100 / 80            | 80      |
| Don Carlos or Otello | 28.7' x 25.6' | 8'     | 735     | 20      | 30          | 18        | 24        | 50 / 40             | 40      |
| Aida (I, II, III)    | 31.6' x 68'   | 9'     | 2148    | 44      | 90          | 42        | 64        | 180 / 150           | 140     |
| Aida I               | 31.6' x 21'   | 9'     | 663     | 20      | 24          | 18        | 24        | 50 / 40             | 40      |
| Aida II              | 31.6' x 25'   | 9'     | 790     | 20      | 24          | 18        | 24        | 50 / 40             | 40      |
| Aida III             | 31.6' x 22'   | 9'     | 695     | 20      | 24          | 18        | 24        | 50 / 40             | 40      |



**HOCKLEY**  
VALLEY RESORT

hockley.com 1-866-HOCKLEY

793522 3rd Line EHS, Mono, ON L9W 5X7  
Toronto: 416-363-5490 Email: info@hockley.com