

# Resort Floor Plan

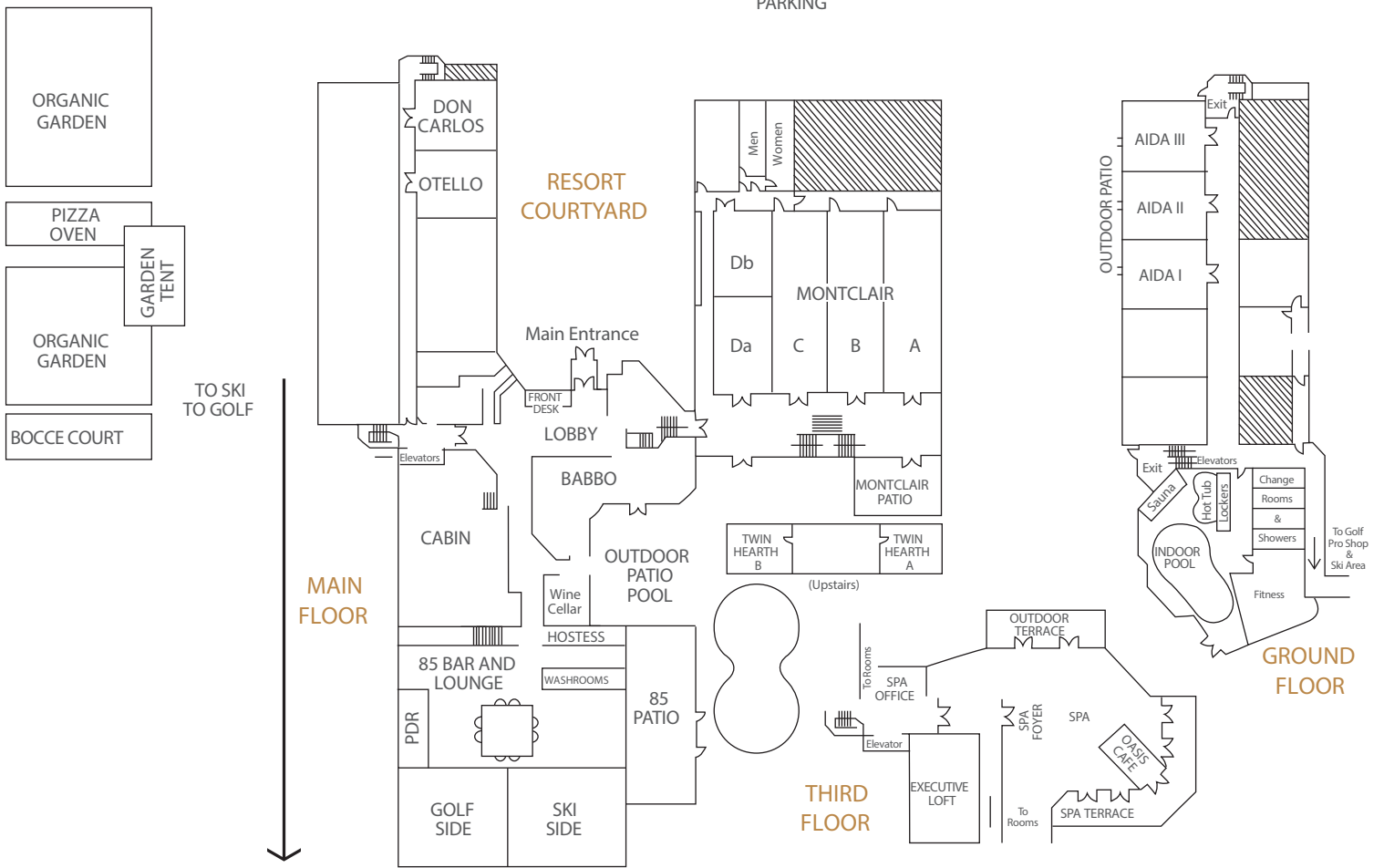

# Meeting Room Specifications

Room	Size	Height	Footage	U-Shape	Rounds of 6	Boardroom	Classroom	Theatre & Reception	Dinner
Montclair (all)	88' x 63'		5544	88	180	74	200	550	450
Montclair (half)	44' x 63'		2772	44	90	38	100	250	160
Montclair A/B/C/D	22' x 63'	12'	1386	36	42	34	48	100	64
Montclair Da	22' x 33'	12'	726	20	24	18	24	50	32 - 40
Montclair Db	22' x 30'	12'	660	16	24	14	16 - 20	50	32
Twin Hearth A	20' x 26'	8'	520			16			
Twin Hearth B	20' x 36'	8'	720			22			
Don Carlos & Otello	28.7' x 51'	8'	1470	36	48	34	48	100 / 80	80
Don Carlos or Otello	28.7' x 25.6'	8'	735	20	30	18	24	50 / 40	40
Aida (I, II, III)	31.6' x 68'	9'	2148	44	90	42	64	180 / 150	140
Aida I	31.6' x 21'	9'	663	20	24	18	24	50 / 40	40
Aida II	31.6' x 25'	9'	790	20	24	18	24	50 / 40	40
Aida III	31.6' x 22'	9'	695	20	24	18	24	50 / 40	40



**HOCKLEY**  
VALLEY RESORT

[hockley.com](http://hockley.com) 1-866-HOCKLEY

793522 3rd Line EHS, Mono, ON L9W 5X7  
Toronto: 416-363-5490 Email: [info@hockley.com](mailto:info@hockley.com)